

Project Name: _____
Job #: _____

CLASS 150# B16.5 FLANGES, A182

WELDING NECK ♥ LAP JOINT ♦ SLIP-ON

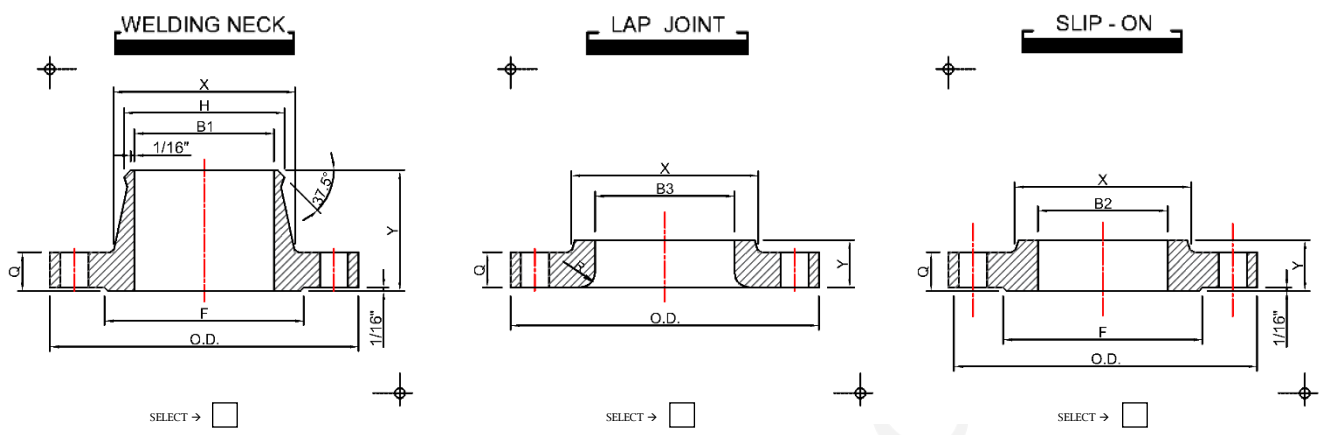

Grade: T304L T316L
 Source: Import Domestic BAA AIS _____
 Face: Raised Face Flat Faced
 Weldnecks & Socketwelds Only: Providing Schedule _____

DIMENSIONS

UOM: Inches/LBS

SELECT	NOM. PIPE SIZE	FLANGE DIAMETER (O.D.)	FLANGE THICKNESS (Q) MIN. (1)	HUB DIA. AT BASE (X)	RAISED FACE DIA. (F)	HUB DIA. AT WELDING POINT (H)	BORE DIAMETER (B)			COUNTER BORE OF THREADED FLANGE (C)	DEPTH OF SOCKET (D)	LENGTH THROUGH HUB (Y)		
							(B1) WELDING NECK AND SOCKET WELD (2)	(B2) SLIP-ON AND SOCKET WELD MIN.	(B3) LAP JOINT MIN			WELDING NECK	SLIP-ON SOCKET WELD AND THREADED	LAP JOINT
<input type="checkbox"/>	1/2	3.50	0.44	1.19	1.38	0.84	0.62	0.88	0.90	NO COUNTER BORE REQUIRE ON 150# THREADED FLANGES	0.38	1.88	0.62	0.62
<input type="checkbox"/>	3/4	3.88	0.50	1.50	1.69	1.05	0.82	1.09	1.11		0.44	2.06	0.62	0.62
<input type="checkbox"/>	1	4.25	0.56	1.94	2.00	1.32	1.05	1.36	1.38		0.50	2.19	0.69	0.69
<input type="checkbox"/>	1 1/4	4.62	0.62	2.31	2.50	1.66	1.38	1.70	1.72		0.56	2.25	0.81	0.81
<input type="checkbox"/>	1 1/2	5.00	0.69	2.56	2.88	1.90	1.61	1.95	1.97		0.62	2.44	0.88	0.88
<input type="checkbox"/>	2	6.00	0.75	3.06	3.62	2.38	2.07	2.44	2.46		0.69	2.50	1.00	1.00
<input type="checkbox"/>	2 1/2	7.00	0.88	3.56	4.12	2.88	2.47	2.94	2.97		0.75	2.75	1.12	1.12
<input type="checkbox"/>	3	7.50	0.94	4.25	5.00	3.50	3.07	3.57	3.60		0.81	2.75	1.19	1.19
<input type="checkbox"/>	3 1/2	8.50	0.94	4.81	5.50	4.00	3.55	4.07	4.10		0.88	2.81	1.25	1.25
<input type="checkbox"/>	4	9.00	0.94	5.31	6.19	4.50	4.03	4.57	4.60		0.94	3.00	1.31	1.31
<input type="checkbox"/>	5	10.00	0.94	6.44	7.31	5.56	5.05	5.66	5.69		0.94	3.50	1.44	1.44
<input type="checkbox"/>	6	11.00	1.00	7.56	8.50	6.63	6.07	6.72	6.75		1.06	3.50	1.56	1.56
<input type="checkbox"/>	8	13.50	1.12	9.69	10.62	8.63	7.98	8.72	8.75		1.25	4.00	1.75	1.75
<input type="checkbox"/>	10	16.00	1.19	12.00	12.75	10.75	10.02	10.88	10.92		1.31	4.00	1.94	1.94
<input type="checkbox"/>	12	19.00	1.25	14.38	14.00	12.75	12.00	12.88	12.92		1.56	4.50	2.19	2.19
<input type="checkbox"/>	14	21.00	1.38	15.75	16.00	14.00	13.25	14.14	14.18		1.63	5.00	2.25	3.12
<input type="checkbox"/>	16	23.50	1.14	18.00	18.00	16.00	15.25	16.16	16.19		1.75	5.00	2.50	3.44
<input type="checkbox"/>	18	25.00	1.56	19.88	20.00	18.00	17.25	18.18	18.20		1.94	5.50	2.69	3.81
<input type="checkbox"/>	20	27.50	1.69	22.00	23.00	20.00	19.25	20.20	20.25		2.12	5.69	2.88	4.06
<input type="checkbox"/>	24	32.00	1.88	26.12	27.25	24.00	23.25	24.25	24.25		2.50	6.00	3.25	4.38

Forged Stainless Steel Material conforms to ASME A182
 Forged Stainless Steel Flange Dimensions conform to ASME B16.5
 NPT Threads conform to ASME B1.20.1
 Plate Stainless Steel Flange Dimensions conform to ASME B16.5 Class 150
 Plate Stainless Steel Flanges made from ASTM A240 Plate or cast in conformance with ASTM A351

Project Name: _____

Job #: _____

CLASS 150# B16.5 FLANGES, A182

THREADED ♣ BLIND ♠ SOCKET WELD

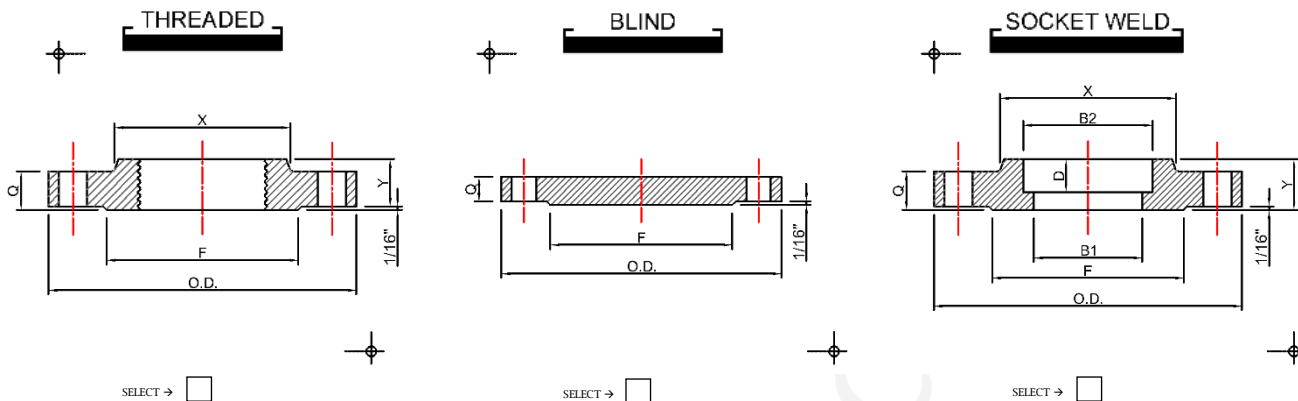

Grade: T304L T316L
 Source: Import Domestic BAA AIS _____
 Face: Raised Face Flat Faced
 Weldnecks & Socketwelds Only: Providing Schedule _____

DIMENSIONS

UOM: Inches/LBS

NOM. PIPE SIZE	MIN. THREAD LENGTH	RADIUS (R) LAP JOINT	DRILLING			BOLTING			
			DIAMETER OF BOLT CIRCLE	NO. OF HOLES	DIA. OF HOLES	DIA. OF BOLTS	MACHINE BOLT LENGTH		
							STUB BOT LENGTH	Raised Face 0.06"	Ring Joint
<input type="checkbox"/> 1/2	0.62	0.12	2.38	4	0.62	1/2	2.00	2.50	-----
<input type="checkbox"/> 3/4	0.62	0.12	2.75	4	0.62	1/2	2.25	2.50	-----
<input type="checkbox"/> 1	0.69	0.12	3.12	4	0.62	1/2	2.25	2.75	3.25
<input type="checkbox"/> 1 1/4	0.81	0.19	3.50	4	0.62	1/2	2.50	2.75	3.25
<input type="checkbox"/> 1 1/2	0.88	0.25	3.88	4	0.62	1/2	2.50	3.00	3.50
<input type="checkbox"/> 2	1.00	0.31	4.75	4	0.75	5/8	2.75	3.25	3.75
<input type="checkbox"/> 2 1/2	1.12	0.31	5.50	4	0.75	5/8	3.00	3.50	4.00
<input type="checkbox"/> 3	1.19	0.38	6.00	4	0.75	5/8	3.25	3.75	4.25
<input type="checkbox"/> 3 1/2	1.25	0.38	7.00	8	0.75	5/8	3.25	3.75	4.25
<input type="checkbox"/> 4	1.31	0.44	7.50	8	0.75	5/8	3.25	3.75	4.25
<input type="checkbox"/> 5	1.44	0.50	8.50	8	0.88	3/4	3.25	4.00	4.50
<input type="checkbox"/> 6	1.56	0.50	9.50	8	0.88	3/4	3.50	4.00	4.50
<input type="checkbox"/> 8	1.75	0.50	11.75	8	0.88	3/4	3.75	4.25	4.75
<input type="checkbox"/> 10	1.94	0.50	14.25	12	1.00	7/8	4.00	4.75	5.25
<input type="checkbox"/> 12	2.19	0.50	17.00	12	1.00	7/8	4.25	4.75	5.25
<input type="checkbox"/> 14	2.25	0.50	18.75	12	1.12	1	4.50	5.25	5.75
<input type="checkbox"/> 16	2.50	0.50	21.25	16	1.12	1	4.75	5.50	6.00
<input type="checkbox"/> 18	2.69	0.50	22.75	16	1.25	1 1/8	5.00	6.00	6.50
<input type="checkbox"/> 20	2.88	0.50	25.00	20	1.25	1 1/8	5.50	6.25	6.75
<input type="checkbox"/> 24	3.25	0.50	29.50	20	1.38	1 1/4	6.00	7.00	7.50

NOM. PIPE SIZE	APPROXIMATE WEIGHT EACH- POUNDS ±			
	WELDING NECK	SLIP-ON SOCKET WELD AND THREADED	LAP JOINT	BLIND
1/2	1.25	1.00	1.00	1.25
3/4	2.00	1.50	1.50	1.50
1	2.50	2.00	2.00	2.00
1 1/4	3.00	3.00	3.00	3.00
1 1/2	4.50	3.00	3.50	4.00
2	6.00	5.25	5.00	6.50
2 1/2	10.00	8.00	7.00	9.50
3	12.00	9.00	9.25	12.50
3 1/2	12.00	11.00	11.00	13.00
4	16.50	12.50	12.50	17.00
5	19.00	15.00	15.00	20.00
6	25.00	19.00	19.00	26.50
8	39.00	30.00	30.00	45.00
10	52.00	43.00	43.00	70.00
12	80.00	64.00	64.00	110.00
14	110.00	90.00	105.00	140.00
16	140.00	98.00	140.00	180.00
18	150.00	130.00	160.00	220.00
20	180.00	165.00	195.00	285.00
24	260.00	220.00	275.00	430.00

Forged Stainless Steel Material conforms to ASME A182
 Forged Stainless Steel Flange Dimensions conform to ASME B16.5
 NPT Threads conform to ASME B1.20.1
 Plate Stainless Steel Flange Dimensions conform to ASME B16.5 Class 150
 Plate Stainless Steel Flanges made from ASTM A240 Plate or cast in conformance with ASTM A351

Project Name: _____
Job #: _____

CLASS 300# B16.5 FLANGES, A182

WELDING NECK ♥ LAP JOINT ♦ SLIP-ON

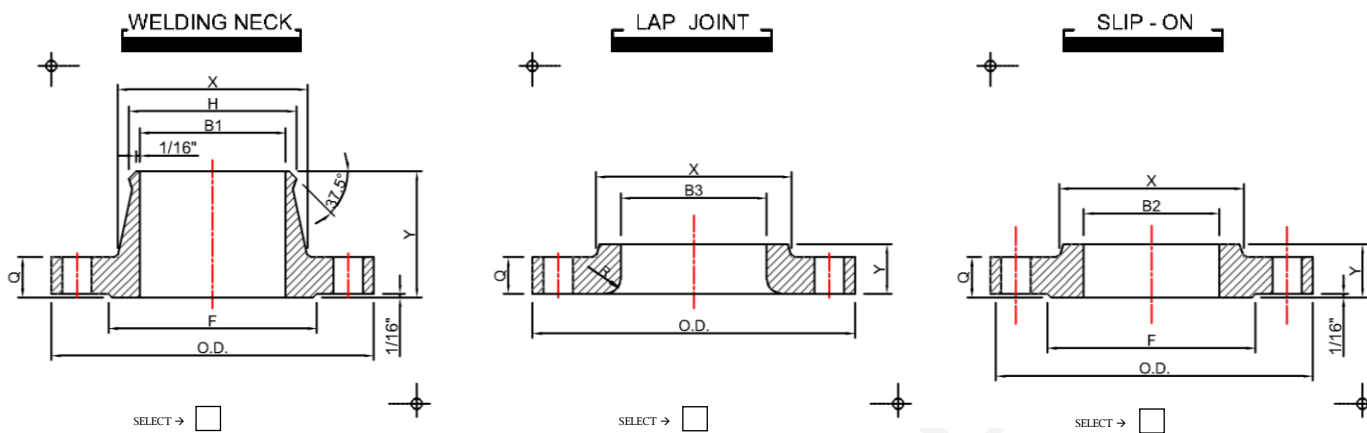

Grade: T304L T316L
 Source: Import Domestic BAA AIS _____
 Face: Raised Face Flat Faced
 Weldnecks & Socketwelds Only: Providing Schedule _____

DIMENSIONS

UOM: Inches/LBS

SELECT	NOM. PIPE SIZE	FLANGE DIAMETER (O.D.)	FLANGE THICKNESS (Q) MIN. (1)	HUB DIA. AT BASE (X)	RAISED FACE DIA. (F)	HUB DIA. AT WELDING POINT (H)	BORE DIAMETER (B)			COUNTER BORE OF THREADED FLANGE (C)	DEPTH OF SOCKET (D)	LENGTH THROUGH HUB (Y)		
							(B1) WELDING NECK AND SOCKET WELD (2)	(B2) SLIP-ON AND SOCKET WELD MIN.	(B3) LAP JOINT MIN			WELDING NECK	SLIP-ON SOCKET WELD AND THREADED	LAP JOINT
<input type="checkbox"/>	1/2	3.75	0.56	1.50	1.38	0.84	0.62	0.88	0.90	0.93	0.38	2.06	0.88	0.88
<input type="checkbox"/>	3/4	4.62	0.62	1.88	1.69	1.05	0.82	1.09	1.11	1.14	0.44	2.25	1.00	1.00
<input type="checkbox"/>	1	4.88	0.69	2.12	2.00	1.32	1.05	1.36	1.38	1.41	0.50	2.44	1.06	1.06
<input type="checkbox"/>	1 1/4	5.25	0.75	2.50	2.50	1.66	1.38	1.70	1.72	1.75	0.56	2.56	1.06	1.06
<input type="checkbox"/>	1 1/2	6.12	0.81	2.75	2.88	1.90	1.61	1.95	1.97	1.99	0.62	2.69	1.19	1.19
<input type="checkbox"/>	2	6.50	0.88	3.31	3.62	2.38	2.07	2.44	2.46	2.50	0.69	2.75	1.31	1.31
<input type="checkbox"/>	2 1/2	7.50	1.00	3.94	4.12	2.88	2.47	2.94	2.97	3.00	0.75	3.00	1.50	1.50
<input type="checkbox"/>	3	8.25	1.12	4.62	5.00	3.50	3.07	3.57	3.60	3.63	0.81	3.12	1.69	1.69
<input type="checkbox"/>	3 1/2	9.00	1.19	5.25	5.50	4.00	3.55	4.07	4.10	4.13	----	3.19	1.75	1.75
<input type="checkbox"/>	4	10.00	1.25	5.75	6.19	4.50	4.03	4.57	4.60	4.63	----	3.38	1.88	1.88
<input type="checkbox"/>	5	11.00	1.38	7.00	7.31	5.56	5.05	5.66	5.69	5.69	----	3.88	2.00	2.00
<input type="checkbox"/>	6	12.50	1.44	8.12	8.50	6.63	6.07	6.72	6.75	6.75	----	3.88	2.06	2.06
<input type="checkbox"/>	8	15.00	1.62	10.25	10.62	8.63	7.98	8.72	8.75	8.75	----	4.38	2.44	2.44
<input type="checkbox"/>	10	17.50	1.88	12.62	12.75	10.75	10.02	10.88	10.92	10.88	----	4.62	2.62	3.75
<input type="checkbox"/>	12	20.50	2.00	14.75	15.00	12.75	12.00	12.88	12.92	12.94	----	5.12	2.88	4.00
<input type="checkbox"/>	14	23.00	2.12	16.75	16.25	14.00	13.25	14.14	14.18	14.19	----	5.62	3.00	4.38
<input type="checkbox"/>	16	25.50	2.25	19.00	18.50	16.00	15.25	16.16	16.19	16.19	----	5.75	3.25	4.75
<input type="checkbox"/>	18	28.00	2.38	21.00	21.00	18.00	17.25	18.18	18.20	18.19	----	6.25	3.50	5.12
<input type="checkbox"/>	20	30.50	2.50	23.12	23.00	20.00	19.25	20.20	20.25	20.19	----	6.38	3.75	5.50
<input type="checkbox"/>	24	36.00	2.75	27.62	27.50	24.00	23.25	24.25	24.25	24.19	----	6.62	4.19	6.00

Forged Stainless Steel Material conforms to ASME A182
 Forged Stainless Steel Flange Dimensions conform to ASME B16.5
 NPT Threads conform to ASME B1.20.1
 Plate Stainless Steel Flange Dimensions conform to ASME B16.5 Class 150
 Plate Stainless Steel Flanges made from ASTM A240 Plate or
 cast in conformance with ASTM A351

Project Name: _____
Job #: _____

CLASS 300# B16.5 FLANGES, A182

WELDING NECK ♥ LAP JOINT ♦ SLIP-ON

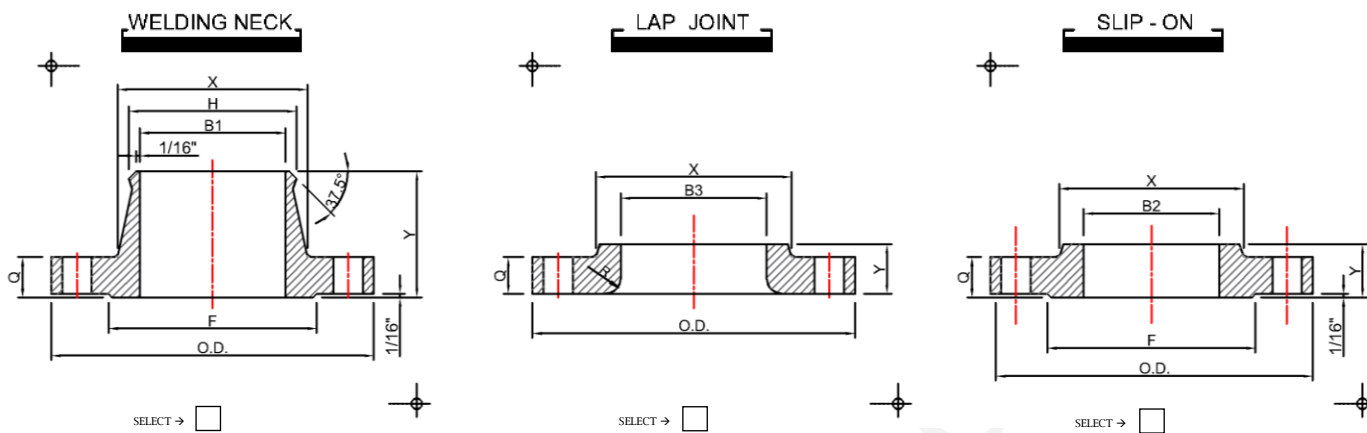

Grade: T304L T316L
 Source: Import Domestic BAA AIS _____
 Face: Raised Face Flat Faced
 Weldnecks & Socketwelds Only: Providing Schedule _____

DIMENSIONS

UOM: Inches/LBS

SELECT	NOM. PIPE SIZE	FLANGE DIAMETER (O.D.)	FLANGE THICKNESS (Q) MIN. (1)	HUB DIA. AT BASE (X)	RAISED FACE DIA. (F)	HUB DIA. AT WELDING POINT (H)	BORE DIAMETER (B)			COUNTER BORE OF THREADED FLANGE (C)	DEPTH OF SOCKET (D)	LENGTH THROUGH HUB (Y)		
							(B1) WELDING NECK AND SOCKET WELD (2)	(B2) SLIP-ON AND SOCKET WELD MIN.	(B3) LAP JOINT MIN			WELDING NECK	SLIP-ON SOCKET WELD AND THREADED	LAP JOINT
<input type="checkbox"/>	1/2	3.75	0.56	1.50	1.38	0.84	0.62	0.88	0.90	0.93	0.38	2.06	0.88	0.88
<input type="checkbox"/>	3/4	4.62	0.62	1.88	1.69	1.05	0.82	1.09	1.11	1.14	0.44	2.25	1.00	1.00
<input type="checkbox"/>	1	4.88	0.69	2.12	2.00	1.32	1.05	1.36	1.38	1.41	0.50	2.44	1.06	1.06
<input type="checkbox"/>	1 1/4	5.25	0.75	2.50	2.50	1.66	1.38	1.70	1.72	1.75	0.56	2.56	1.06	1.06
<input type="checkbox"/>	1 1/2	6.12	0.81	2.75	2.88	1.90	1.61	1.95	1.97	1.99	0.62	2.69	1.19	1.19
<input type="checkbox"/>	2	6.50	0.88	3.31	3.62	2.38	2.07	2.44	2.46	2.50	0.69	2.75	1.31	1.31
<input type="checkbox"/>	2 1/2	7.50	1.00	3.94	4.12	2.88	2.47	2.94	2.97	3.00	0.75	3.00	1.50	1.50
<input type="checkbox"/>	3	8.25	1.12	4.62	5.00	3.50	3.07	3.57	3.60	3.63	0.81	3.12	1.69	1.69
<input type="checkbox"/>	3 1/2	9.00	1.19	5.25	5.50	4.00	3.55	4.07	4.10	4.13	----	3.19	1.75	1.75
<input type="checkbox"/>	4	10.00	1.25	5.75	6.19	4.50	4.03	4.57	4.60	4.63	----	3.38	1.88	1.88
<input type="checkbox"/>	5	11.00	1.38	7.00	7.31	5.56	5.05	5.66	5.69	5.69	----	3.88	2.00	2.00
<input type="checkbox"/>	6	12.50	1.44	8.12	8.50	6.63	6.07	6.72	6.75	6.75	----	3.88	2.06	2.06
<input type="checkbox"/>	8	15.00	1.62	10.25	10.62	8.63	7.98	8.72	8.75	8.75	----	4.38	2.44	2.44
<input type="checkbox"/>	10	17.50	1.88	12.62	12.75	10.75	10.02	10.88	10.92	10.88	----	4.62	2.62	3.75
<input type="checkbox"/>	12	20.50	2.00	14.75	15.00	12.75	12.00	12.88	12.92	12.94	----	5.12	2.88	4.00
<input type="checkbox"/>	14	23.00	2.12	16.75	16.25	14.00	13.25	14.14	14.18	14.19	----	5.62	3.00	4.38
<input type="checkbox"/>	16	25.50	2.25	19.00	18.50	16.00	15.25	16.16	16.19	16.19	----	5.75	3.25	4.75
<input type="checkbox"/>	18	28.00	2.38	21.00	21.00	18.00	17.25	18.18	18.20	18.19	----	6.25	3.50	5.12
<input type="checkbox"/>	20	30.50	2.50	23.12	23.00	20.00	19.25	20.20	20.25	20.19	----	6.38	3.75	5.50
<input type="checkbox"/>	24	36.00	2.75	27.62	27.50	24.00	23.25	24.25	24.25	24.19	----	6.62	4.19	6.00

Forged Stainless Steel Material conforms to ASME A182
 Forged Stainless Steel Flange Dimensions conform to ASME B16.5
 NPT Threads conform to ASME B1.20.1
 Plate Stainless Steel Flange Dimensions conform to ASME B16.5 Class 150
 Plate Stainless Steel Flanges made from ASTM A240 Plate or
 cast in conformance with ASTM A351

Project Name: _____
 Job #: _____

CLASS 600# B16.5 FLANGES, A182
WELDING NECK ♥ LAP JOINT ♦ SLIP-ON

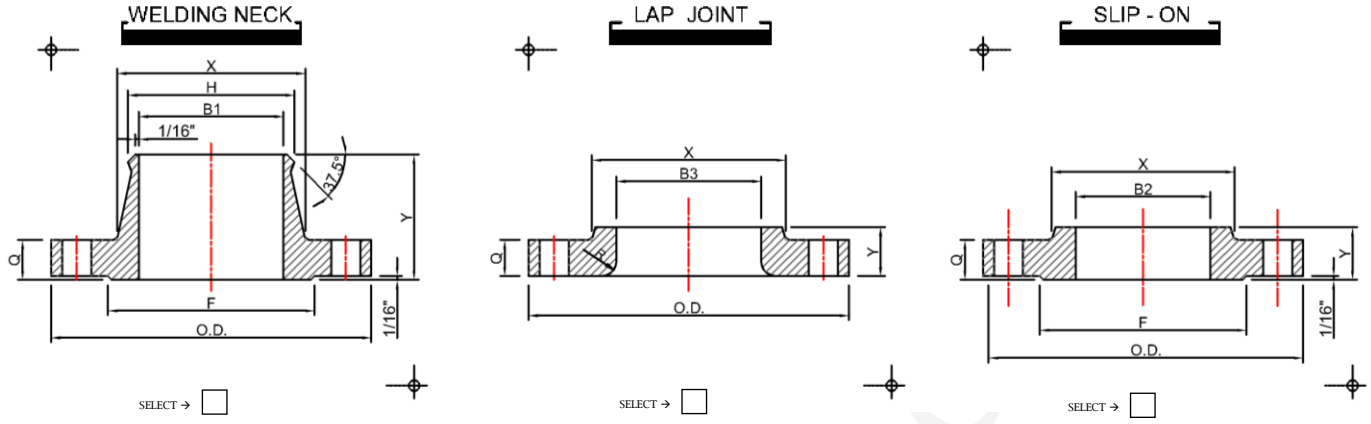

Grade: T304L T316L
 Source: Import Domestic BAA AIS _____
 Face: Raised Face Flat Faced
 Weldnecks & Socketwelds Only: Providing Schedule _____

DIMENSIONS
 UOM: Inches/LBS

NOM. PIPE SIZE	FLANGE DIAMETER (O.D.)	FLANGE THICKNESS (Q) MIN. (1)	HUB DIA. AT BASE (X)	RAISED FACE DIA. (F)	HUB DIA. AT WELDING POINT (H)	BORE DIAMETER (B)			COUNTER BORE OF THREADED FLANGE (C)	DEPTH OF SOCKET (D)	LENGTH THROUGH HUB (Y)		
						(B1) WELDING NECK AND SOCKET WELD (2)	(B2) SLIP-ON AND SOCKET WELD MIN.	(B3) LAP JOINT MIN			WELDING NECK	SLIP-ON SOCKET WELD AND THREADED	LAP JOINT
<input type="checkbox"/> 1/2	3.75	0.56	1.50	1.38	0.84	TO BE SPECIFIED BY PURCHASER	0.88	0.90	0.93	0.38	2.06	0.88	0.88
<input type="checkbox"/> 3/4	4.62	0.62	1.88	1.69	1.05		1.09	1.11	1.14	0.44	2.25	1.00	1.00
<input type="checkbox"/> 1	4.88	0.69	2.12	2.00	1.32		1.36	1.38	1.41	0.50	2.44	1.06	1.06
<input type="checkbox"/> 1 1/4	5.25	0.81	2.50	2.50	1.66		1.70	1.72	1.75	0.56	2.62	1.12	1.12
<input type="checkbox"/> 1 1/2	6.12	0.88	2.75	2.88	1.90		1.95	1.97	1.99	0.62	2.75	1.25	1.25
<input type="checkbox"/> 2	6.50	1.00	3.31	3.62	2.38		2.44	2.46	2.50	0.69	2.88	1.44	1.44
<input type="checkbox"/> 2 1/2	7.50	1.12	3.94	4.12	2.88		2.94	2.97	3.00	0.75	3.12	1.62	1.62
<input type="checkbox"/> 3	8.25	1.25	4.62	5.00	3.50		3.57	3.60	3.63	0.81	3.25	1.81	1.81
<input type="checkbox"/> 3 1/2	9.00	1.38	5.25	5.50	4.00		4.07	4.10	4.13	-----	3.38	1.94	1.94
<input type="checkbox"/> 4	10.75	1.50	6.00	6.19	4.50		4.57	4.60	4.63	-----	4.00	2.12	2.12
<input type="checkbox"/> 5	13.00	1.75	7.44	7.31	5.56		5.66	5.69	5.69	-----	4.50	2.38	2.38
<input type="checkbox"/> 6	14.00	1.88	8.75	8.50	6.63		6.72	6.75	6.75	-----	4.62	2.62	2.62
<input type="checkbox"/> 8	16.50	2.19	10.75	10.62	8.63		8.72	8.75	8.75	-----	5.25	3.00	3.00
<input type="checkbox"/> 10	20.00	2.50	13.50	12.75	10.75		10.88	10.92	10.88	-----	6.00	3.38	4.38
<input type="checkbox"/> 12	22.00	2.62	15.75	15.00	12.75		12.88	12.92	12.94	-----	6.12	3.62	4.62
<input type="checkbox"/> 14	23.75	2.75	17.00	16.25	14.00		14.14	14.18	14.19	-----	6.50	3.69	5.00
<input type="checkbox"/> 16	27.00	3.00	19.50	18.50	16.00		16.16	16.19	16.19	-----	7.00	4.19	5.50
<input type="checkbox"/> 18	29.25	3.25	21.50	21.00	18.00		18.18	18.20	18.19	-----	7.25	4.62	6.00
<input type="checkbox"/> 20	32.00	3.50	24.00	23.00	20.00		20.20	20.25	20.19	-----	7.50	5.00	6.50
<input type="checkbox"/> 24	37.00	4.00	28.25	27.25	24.00		24.25	24.25	24.19	-----	8.00	5.50	7.25

Forged Stainless Steel Material conforms to ASME A182
 Forged Stainless Steel Flange Dimensions conform to ASME B16.5
 NPT Threads conform to ASME B1.20.1
 Plate Stainless Steel Flange Dimensions conform to ASME B16.5 Class 150
 Plate Stainless Steel Flanges made from ASTM A240 Plate or cast in conformance with ASTM A351



Project Name: _____

Job #: _____

CLASS 600# B16.5 FLANGES, A182

THREADED ♣ BLIND ♠ SOCKET WELD

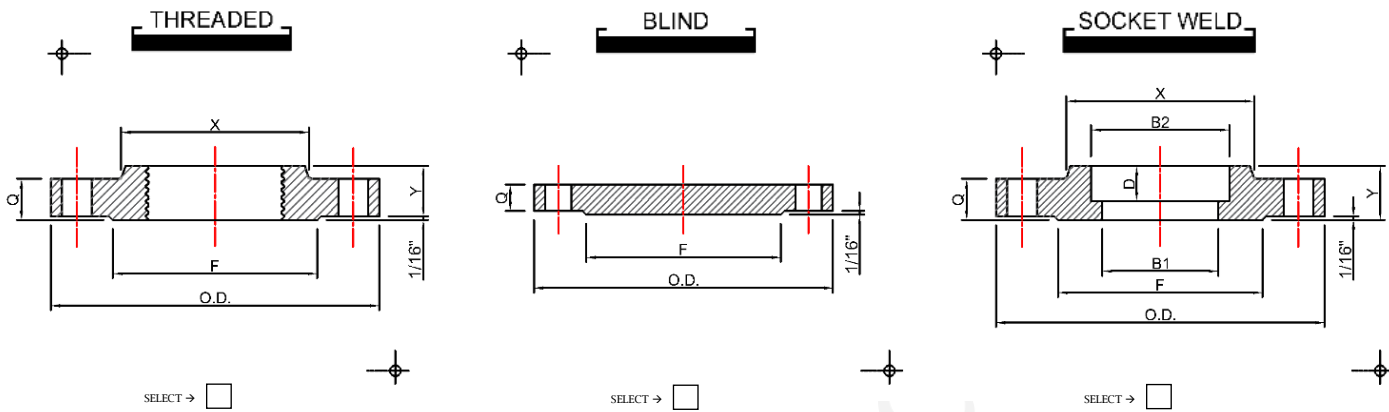

Grade: T304L T316L
 Source: Import Domestic BAA AIS _____
 Face: Raised Face Flat Faced
 Weldnecks & Socketwelds Only: Providing Schedule _____

DIMENSIONS

UOM: Inches/LBS

SELECT	NOM. PIPE SIZE	MIN. THREAD LENGTH	RADIUS (R) LAP JOINT	DRILLING			BOLTING			APPROXIMATE WEIGHT EACH- POUNDS ±					
				DIAMETER OF BOLT CIRCLE	NO. OF HOLES	DIA. OF HOLES	DIA. OF BOLTS	MACHINE BOLT LENGTH		STUB BOT LENGTH	WELDING NECK	SLIP-ON SOCKET WELD AND THREADED	LAP JOINT	BLIND	
								Raised Face 0.06"	Ring Joint						
<input type="checkbox"/>	1/2	0.62	0.12	2.62	4	0.62	1/2	3.25	3.00	3.00	1/2	2	2	2	2
<input type="checkbox"/>	3/4	0.62	0.12	3.25	4	0.75	5/8	3.50	3.25	3.50	3/4	4	3	3	3
<input type="checkbox"/>	1	0.69	0.12	3.50	4	0.75	5/8	3.75	3.50	3.75	1	4	4	4	4
<input type="checkbox"/>	1 1/4	0.81	0.19	3.88	4	0.75	5/8	4.00	3.75	4.00	1 1/4	6	5	5	5
<input type="checkbox"/>	1 1/2	0.88	0.25	4.50	4	0.88	3/4	4.25	4.00	4.25	1 1/2	8	7	7	8
<input type="checkbox"/>	2	1.12	0.31	5.00	8	0.75	5/8	4.25	4.00	4.50	2	12	9	9	10
<input type="checkbox"/>	2 1/2	1.25	0.31	5.88	8	0.88	3/4	4.75	4.50	5.00	2 1/2	18	13	12	15
<input type="checkbox"/>	3	1.38	0.38	6.62	8	0.88	3/4	5.00	4.75	5.25	3	23	16	15	0
<input type="checkbox"/>	3 1/2	1.56	0.38	7.25	8	1.00	7/8	5.50	5.25	5.75	3 1/2	26	21	20	29
<input type="checkbox"/>	4	1.62	0.44	8.50	8	1.00	7/8	5.75	5.50	6.00	4	42	37	36	41
<input type="checkbox"/>	5	1.88	0.44	10.50	8	1.12	1	6.50	6.25	6.75	5	68	63	61	68
<input type="checkbox"/>	6	2.00	0.50	11.50	12	1.12	1	6.75	6.50	7.00	6	81	80	78	86
<input type="checkbox"/>	8	2.25	0.50	13.75	12	1.25	1 1/8	7.75	7.50	7.75	8	120	115	110	140
<input type="checkbox"/>	10	2.56	0.50	17.00	16	1.38	1 1/4	8.50	8.25	8.75	10	190	170	170	230
<input type="checkbox"/>	12	2.75	0.50	19.25	20	1.38	1 1/4	8.75	8.50	9.00	12	225	200	200	295
<input type="checkbox"/>	14	2.88	0.50	20.75	20	1.50	1 3/8	9.25	9.00	9.50	14	280	230	250	355
<input type="checkbox"/>	16	3.06	0.50	23.75	20	1.62	1 1/2	10.00	9.75	10.25	16	390	330	365	495
<input type="checkbox"/>	18	3.12	0.50	25.75	20	1.75	1 5/8	10.75	10.50	11.00	18	475	400	435	630
<input type="checkbox"/>	20	3.25	0.50	28.50	24	1.75	1 5/8	11.25	11.25	11.75	20	590	510	570	810
<input type="checkbox"/>	24	3.62	0.50	33.00	24	2.00	1 7/8	12.75	12.75	13.25	24	830	730	810	1250

Forged Stainless Steel Material conforms to ASME A182
 Forged Stainless Steel Flange Dimensions conform to ASME B16.5
 NPT Threads conform to ASME B1.20.1
 Plate Stainless Steel Flange Dimensions conform to ASME B16.5 Class 150
 Plate Stainless Steel Flanges made from ASTM A240 Plate or
 cast in conformance with ASTM A351

Project Name: _____
Job #: _____

CLASS 1500# B16.5 FLANGES, A182

WELDING NECK ♥ LAP JOINT ♦ SLIP-ON

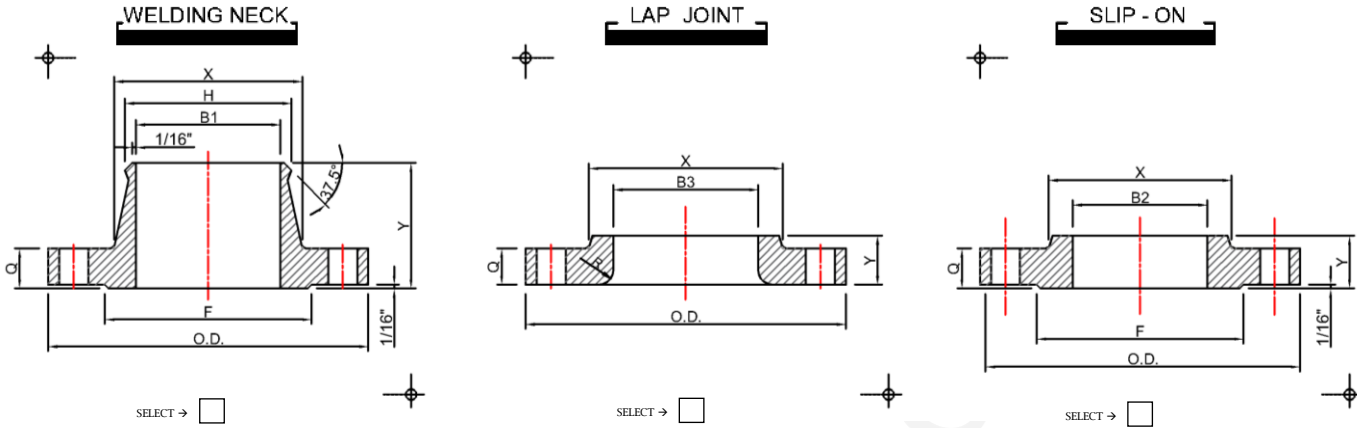

Grade: T304L T316L
 Source: Import Domestic BAA AIS _____
 Face: Raised Face Flat Faced
 Weldnecks & Socketwelds Only: Providing Schedule _____

DIMENSIONS

UOM: Inches/LBS

SELECT	NOM. PIPE SIZE	FLANGE DIAMETER (O.D.)	FLANGE THICKNESS (Q) MIN. (1)	HUB DIA. AT BASE (X)	RAISED FACE DIA. (F)	HUB DIA. AT WELDING POINT (H)	BORE DIAMETER (B)			COUNTER BORE OF THREADED FLANGE (C)	DEPTH OF SOCKET (D)	LENGTH THROUGH HUB (Y)		
							(B1) WELDING NECK AND SOCKET WELD (2)	(B2) SLIP-ON AND SOCKET WELD MIN.	(B3) LAP JOINT MIN			WELDING NECK	SLIP-ON SOCKET WELD AND THREADED	LAP JOINT
<input type="checkbox"/>	1/2	4.75	0.88	1.50	1.38	0.84	TO BE SPECIFIED BY PURCHASER	0.88	0.90	0.93	0.38	2.38	1.25	1.25
<input type="checkbox"/>	3/4	5.12	1.00	1.75	1.69	1.05		1.09	1.11	1.14	0.44	2.75	1.38	1.38
<input type="checkbox"/>	1	5.88	1.12	2.06	2.00	1.32		1.36	1.38	1.41	0.50	2.88	1.62	1.62
<input type="checkbox"/>	1 1/4	6.25	1.12	2.50	2.50	1.66		1.70	1.72	1.75	0.56	2.88	1.62	1.62
<input type="checkbox"/>	1 1/2	7.00	1.25	2.75	2.88	1.90		1.95	1.97	1.99	0.62	3.25	1.75	1.75
<input type="checkbox"/>	2	8.50	1.50	4.12	3.62	2.38		2.44	2.46	2.50	0.69	4.00	2.25	2.25
<input type="checkbox"/>	2 1/2	9.62	1.62	4.88	4.12	2.88		2.94	2.97	3.00	0.75	4.12	2.50	2.50
<input type="checkbox"/>	3	10.50	1.88	5.25	5.00	3.50		-----	3.60	3.63	-----	4.62	2.88	2.88
<input type="checkbox"/>	4	12.25	2.12	6.38	6.19	4.50		-----	4.60	4.63	-----	4.88	3.56	3.56
<input type="checkbox"/>	5	14.75	2.88	7.75	7.31	5.56		-----	5.69	5.69	-----	6.12	4.12	4.12
<input type="checkbox"/>	6	15.50	3.25	9.00	8.50	6.63		-----	6.75	6.75	-----	6.75	4.69	4.69
<input type="checkbox"/>	8	19.00	3.62	11.50	10.62	8.63		-----	8.75	8.75	-----	8.38	5.62	5.62
<input type="checkbox"/>	10	23.00	4.25	14.50	12.75	10.75		-----	10.92	10.88	-----	10.00	6.25	7.00
<input type="checkbox"/>	12	26.50	4.88	17.75	15.00	12.75		-----	12.92	12.94	-----	11.12	7.12	8.62
<input type="checkbox"/>	14	29.50	5.25	19.50	16.25	14.00		-----	14.18	14.19	-----	11.75	-----	9.50
<input type="checkbox"/>	16	32.50	5.75	21.75	18.50	16.00		-----	16.19	16.19	-----	12.25	-----	10.25
<input type="checkbox"/>	18	36.00	6.38	23.50	21.00	18.00		-----	18.20	18.19	-----	12.88	-----	10.88
<input type="checkbox"/>	20	38.75	7.00	25.25	23.00	20.00		-----	20.25	20.19	-----	14.00	-----	11.50
<input type="checkbox"/>	24	46.00	8.00	30.00	27.25	24.00		-----	24.25	24.19	-----	16.00	-----	13.00

Forged Stainless Steel Material conforms to ASME A182
 Forged Stainless Steel Flange Dimensions conform to ASME B16.5
 NPT Threads conform to ASME B1.20.1
 Plate Stainless Steel Flange Dimensions conform to ASME B16.5 Class 150
 Plate Stainless Steel Flanges made from ASTM A240 Plate or
 cast in conformance with ASTM A351

Project Name: _____
Job #: _____

CLASS 1500# B16.5 FLANGES, A182
THREADED ♣ BLIND ♠ SOCKET WELD

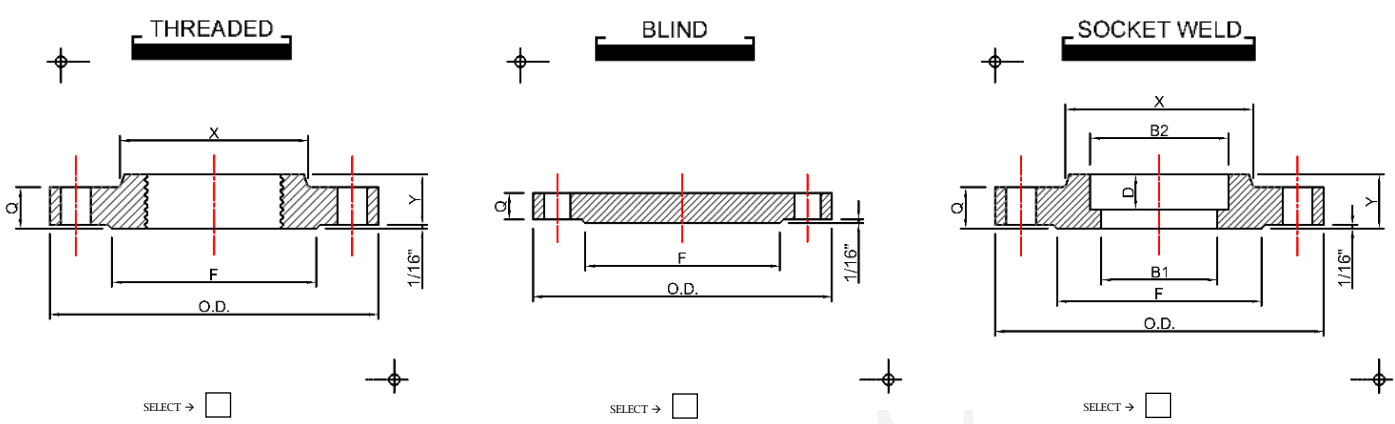

Grade: T304L T316L
 Source: Import Domestic BAA AIS _____
 Face: Raised Face Flat Faced
 Weldnecks & Socketwelds Only: Providing Schedule _____

DIMENSIONS

UOM: Inches/LBS

NOM. PIPE SIZE	MIN. THREAD LENGTH	RADIUS (R) LAP JOINT	DRILLING			BOLTING				APPROXIMATE WEIGHT EACH- POUNDS ±				
			DIAMETER OF BOLT CIRCLE	NO. OF HOLES	DIA. OF HOLES	DIA. OF BOLTS	STUB BOT LENGTH			WELDING NECK	SLIP-ON SOCKET WELD AND THREADED	LAP JOINT	BLIND	
							25° Raised Face	Male & Female Tongue & Groove	Ring Joint					
<input type="checkbox"/> 1/2	0.88	0.12	3.25	4	0.88	3/4	4.25	4.00	4.25	1/2	5	4	4	4
<input type="checkbox"/> 3/4	1.00	0.12	3.50	4	0.88	3/4	4.50	4.25	4.50	3/4	6	5	5	5
<input type="checkbox"/> 1	1.12	0.12	4.00	4	1.00	7/8	5.00	4.75	5.00	1	9	8	8	8
<input type="checkbox"/> 1 1/4	1.19	0.19	4.38	4	1.00	7/8	5.00	4.75	5.00	1 1/4	10	9	9	9
<input type="checkbox"/> 1 1/2	1.25	0.25	4.88	4	1.12	1	5.50	5.25	5.50	1 1/2	13	12	12	13
<input type="checkbox"/> 2	1.50	0.31	6.50	8	1.00	7/8	5.75	5.50	5.75	2	25	25	25	25
<input type="checkbox"/> 2 1/2	1.88	0.31	7.50	8	1.12	1	6.25	6.00	6.25	2 1/2	36	36	35	35
<input type="checkbox"/> 3	2.00	0.38	8.00	8	1.25	1 1/8	7.00	6.75	7.00	3	48	48	47	48
<input type="checkbox"/> 4	2.25	0.44	9.25	8	1.38	1 1/4	7.75	7.50	7.75	4	73	73	75	73
<input type="checkbox"/> 5	2.50	0.44	11.50	8	1.62	1 1/2	9.75	9.50	9.75	5	130	130	140	140
<input type="checkbox"/> 6	2.75	0.50	12.50	12	1.50	1 3/8	10.25	10.00	10.50	6	165	165	170	160
<input type="checkbox"/> 8	3.00	0.50	15.50	12	1.75	1 5/8	11.50	11.25	12.00	8	275	260	285	300
<input type="checkbox"/> 10	3.31	0.50	19.00	12	2.00	1 7/8	13.25	13.00	13.75	10	455	435	485	510
<input type="checkbox"/> 12	3.62	0.50	22.50	16	2.12	2	14.75	14.50	15.50	12	690	580	630	690
<input type="checkbox"/> 14	-----	0.50	25.00	16	2.38	2 1/4	16.00	15.75	17.00	14	940	-----	890	975
<input type="checkbox"/> 16	-----	0.50	27.75	16	2.62	2 1/2	17.50	17.25	18.50	16	1250	-----	1150	1300
<input type="checkbox"/> 18	-----	0.50	30.50	16	2.88	2 3/4	19.50	19.00	20.50	18	1625	-----	1475	1750
<input type="checkbox"/> 20	-----	0.50	32.75	16	3.12	3	21.50	21.00	22.50	20	2050	-----	1775	2225
<input type="checkbox"/> 24	-----	0.50	39.00	16	3.62	3 1/2	24.50	24.00	25.75	24	3325	-----	2825	3625

Forged Stainless Steel Material conforms to ASME A182
 Forged Stainless Steel Flange Dimensions conform to ASME B16.5
 NPT Threads conform to ASME B1.20.1
 Plate Stainless Steel Flange Dimensions conform to ASME B16.5 Class 150
 Plate Stainless Steel Flanges made from ASTM A240 Plate or cast in conformance with ASTM A351



Project Name: _____
 Job #: _____

CLASS 2500# B16.5 FLANGES, A182

WELDING NECK ♥ LAP JOINT ♦ SLIP-ON

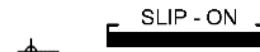
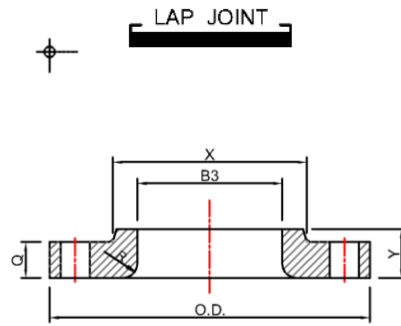
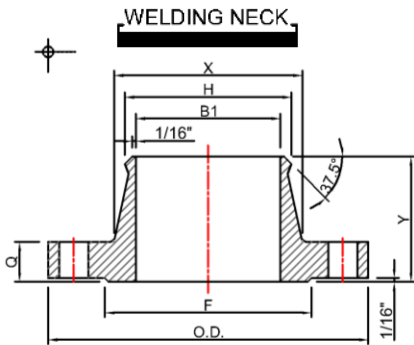

**SLIP-ON IS NOT
 PRODUCED IN CLASS
 2500**

SELECT →

SELECT →

SELECT →

Grade: T304L T316L
 Source: Import Domestic BAA AIS _____
 Face: Raised Face Flat Faced
 Weldnecks & Socketwelds Only: Providing Schedule _____

DIMENSIONS

UOM: Inches/LBS

SELECT	NOM. PIPE SIZE	FLANGE DIAMETER (O.D.)	FLANGE THICKNESS (Q) MIN. (1)	HUB DIA. AT BASE (X)	RAISED FACE DIA. (F)	HUB DIA. AT WELDING POINT (H)	BORE DIAMETER (B)		COUNTER BORE OF THREADED FLANGE (C)	LENGTH THROUGH HUB (Y)		
							(B1) WELDING NECK (2)	(B3) LAP JOINT MIN		WELDING NECK	SLIP-ON AND THREADED	LAP JOINT
<input type="checkbox"/>	1/2	5.25	1.19	1.69	1.38	0.84	TO BE SPECIFIED BY PURCHASER	0.90	0.93	2.88	1.56	1.56
<input type="checkbox"/>	3/4	5.50	1.25	2.00	1.69	1.05		1.11	1.14	3.12	1.69	1.69
<input type="checkbox"/>	1	6.25	1.38	2.25	2.00	1.32		1.38	1.41	3.50	1.88	1.88
<input type="checkbox"/>	1 1/4	7.25	1.50	2.88	2.50	1.66		1.72	1.75	3.75	2.06	2.06
<input type="checkbox"/>	1 1/2	8.00	1.75	3.12	2.88	1.90		1.97	1.99	4.38	2.38	2.38
<input type="checkbox"/>	2	9.25	2.00	3.75	3.62	2.38		2.46	2.50	5.00	2.75	2.75
<input type="checkbox"/>	2 1/2	10.50	2.25	4.50	4.12	2.88		2.97	3.00	5.62	3.12	3.12
<input type="checkbox"/>	3	12.00	2.62	5.25	5.00	3.50		3.60	3.63	6.62	3.62	3.62
<input type="checkbox"/>	4	14.00	3.00	6.50	6.19	4.50		4.60	4.63	7.50	4.25	4.25
<input type="checkbox"/>	5	16.50	3.62	8.00	7.31	5.56		5.69	5.69	9.00	5.12	5.12
<input type="checkbox"/>	6	19.00	4.25	9.25	8.50	6.63		6.75	6.75	10.75	6.00	6.00
<input type="checkbox"/>	8	21.75	5.00	12.00	10.62	8.63		8.75	8.75	12.50	7.00	7.00
<input type="checkbox"/>	10	26.50	6.50	14.75	12.75	10.75		10.92	10.88	16.50	9.00	9.00
<input type="checkbox"/>	12	30.00	7.25	17.38	15.00	12.75		12.92	12.94	18.25	10.00	10.00

Forged Stainless Steel Material conforms to ASME A182
 Forged Stainless Steel Flange Dimensions conform to ASME B16.5
 NPT Threads conform to ASME B1.20.1
 Plate Stainless Steel Flange Dimensions conform to ASME B16.5 Class 150
 Plate Stainless Steel Flanges made from ASTM A240 Plate or
 cast in conformance with ASTM A351

Project Name: _____

Job #: _____

CLASS 2500# B16.5 FLANGES, A182

THREADED ♣ BLIND ♠ SOCKET WELD

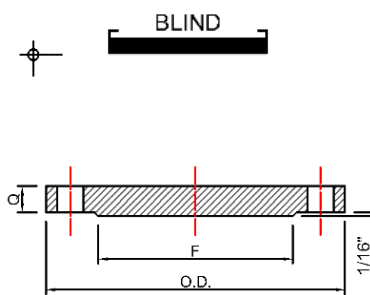
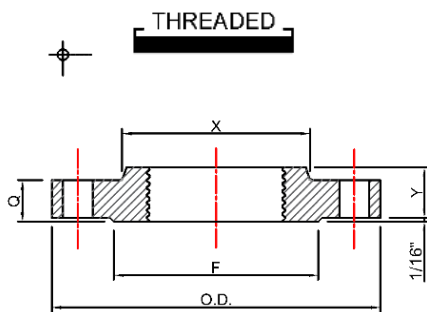

**SOCKETWELD IS NOT
PRODUCED IN CLASS
2500**

SELECT →

SELECT →

SELECT →

Grade: T304L T316L
 Source: Import Domestic BAA AIS _____
 Face: Raised Face Flat Faced
 Weldnecks & Socketwelds Only: Providing Schedule _____

DIMENSIONS

UOM: Inches/LBS

SELECT	NOM. PIPE SIZE	MIN. THREAD LENGTH	RADIUS (R) LAP JOINT	DRILLING			BOLTING			
				DIAMETER OF BOLT CIRCLE	NO. OF HOLES	DIA. OF HOLES	DIA. OF BOLTS	STUB BOT LENGTH		
								25° Raised Face	Male & Female Tongue & Groove	Ring Joint
<input type="checkbox"/>	1/2	1.12	0.12	3.50	4	0.88	3/4	5.25	5.00	5.25
<input type="checkbox"/>	3/4	1.25	0.12	3.75	4	0.88	3/4	5.25	5.00	5.25
<input type="checkbox"/>	1	1.38	0.12	4.25	4	1.00	7/8	5.75	5.50	5.75
<input type="checkbox"/>	1 1/4	1.50	0.19	5.12	4	1.12	1	6.25	6.00	6.50
<input type="checkbox"/>	1 1/2	1.75	0.25	5.75	4	1.25	7/8	7.00	6.75	7.25
<input type="checkbox"/>	2	2.00	0.31	6.75	8	1.12	1	7.25	7.00	7.50
<input type="checkbox"/>	2 1/2	2.25	0.31	7.75	8	1.25	1 1/8	8.00	7.75	8.25
<input type="checkbox"/>	3	2.50	0.38	9.00	8	1.38	1 1/4	9.00	8.75	9.25
<input type="checkbox"/>	4	2.75	0.44	10.75	8	1.62	1 1/2	10.25	10.00	10.75
<input type="checkbox"/>	5	3.00	0.44	12.75	8	1.88	1 3/4	12.00	11.75	12.75
<input type="checkbox"/>	6	3.25	0.50	14.50	8	2.12	2	13.75	13.50	14.50
<input type="checkbox"/>	8	3.75	0.50	17.25	12	2.12	2	15.25	15.00	16.00
<input type="checkbox"/>	10	4.25	0.50	21.25	12	2.62	2 1/2	19.50	19.25	20.50
<input type="checkbox"/>	12	4.75	0.50	24.38	12	2.88	2 3/4	21.50	21.25	22.50

NOM. PIPE SIZE	APPROXIMATE WEIGHT EACH- POUNDS ±			
	WELDING NECK	SLIP-ON AND THREADED	LAP JOINT	BLIND
1/2	7	7	7	7
3/4	8	8	8	8
1	12	11	11	11
1 1/4	17	16	16	17
1 1/2	25	22	22	23
2	42	38	37	39
2 1/2	52	55	53	56
3	94	83	80	86
4	145	125	120	135
5	245	210	205	225
6	380	325	315	345
8	580	485	470	530
10	1075	930	900	1025
12	1525	1100	1100	1300

Forged Stainless Steel Material conforms to ASME A182
 Forged Stainless Steel Flange Dimensions conform to ASME B16.5
 NPT Threads conform to ASME B1.20.1
 Plate Stainless Steel Flange Dimensions conform to ASME B16.5 Class 150
 Plate Stainless Steel Flanges made from ASTM A240 Plate or cast in conformance with ASTM A351

150# BOLT PATTERN BLIND PLATE FLANGES

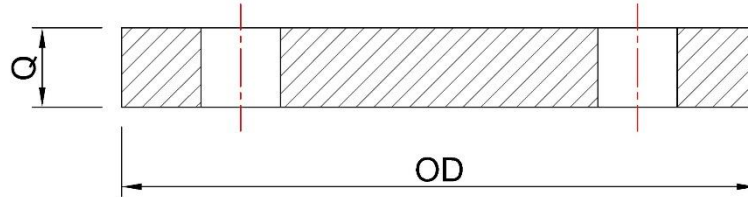

150 BOLT PATTERN
BLIND PLATE FLANGES

Grade: T304L T316L
Source: Import Domestic BAA AIS

DIMENSIONS

UOM: Inches/LBS

SELECT	SIZE	OUTSIDE DIAMETER (O.D.)	THICKNESS (Q)	DIA. OF BOLT HOLES	BOLT CIRCLE	NUMBER OF BOLT HOLES	WEIGHT
<input type="checkbox"/>	1	4.25	0.500	0.62	3.12	4	1.96
<input type="checkbox"/>	1 ¼	4.62	0.500	0.62	3.50	4	2.36
<input type="checkbox"/>	1 ½	5.00	0.500	0.62	3.88	4	2.78
<input type="checkbox"/>	2	6.00	0.500	0.75	4.75	4	4.01
<input type="checkbox"/>	2 ½	7.00	0.500	0.75	5.50	4	5.56
<input type="checkbox"/>	3	7.50	0.500	0.75	6.00	4	6.39
<input type="checkbox"/>	4	9.00	0.500	0.75	7.50	8	9.06
<input type="checkbox"/>	5	10.00	0.500	0.88	8.50	8	11.13
<input type="checkbox"/>	6	11.00	0.500	0.88	9.50	8	13.60
<input type="checkbox"/>	8	13.50	0.500	0.88	11.75	8	20.81
<input type="checkbox"/>	10	16.00	0.500	1.00	14.25	12	42.75
<input type="checkbox"/>	12	19.00	0.500	1.00	17.00	12	61.29

Plate Stainless Steel Flange Dimensions conform to ASME B16.5 Class 150
Plate Stainless Steel Flanges made from ASTM A240 Plate
Cast in conformance with ASTM A35

Project Name: _____
Job #: _____

150# BOLT PATTERN PIPE PLATE FLANGES

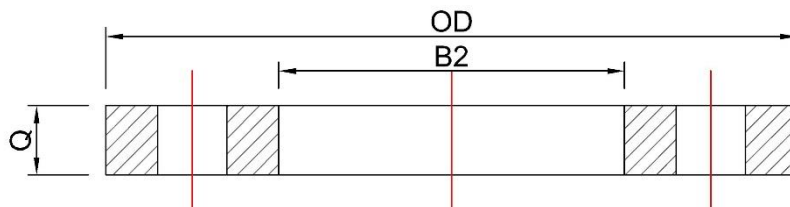

150 BOLT PATTERN
PIPE PLATE FLANGES

Grade: T304L T316L
Source: Import Domestic BAA AIS

DIMENSIONS

UOM: Inches/LBS

SELECT	SIZE	OUTSIDE DIAMETER (O.D.)	INSIDE DIAMETER (B2)	THICKNESS (Q)	DIA. OF BOLT HOLES	BOLT CIRCLE	NUMBER OF BOLT HOLES	WEIGHT
<input type="checkbox"/>	½	3.50	0.88	0.500	0.625	2.38	4	1.17
<input type="checkbox"/>	¾	3.88	1.09	0.500	0.625	2.75	4	1.45
<input type="checkbox"/>	1	4.25	1.36	0.500	0.625	3.12	4	1.73
<input type="checkbox"/>	1 ¼	4.62	1.70	0.500	0.625	3.50	4	2.00
<input type="checkbox"/>	1 ½	5.00	1.95	0.500	0.625	3.88	4	2.32
<input type="checkbox"/>	2	6.00	2.44	0.500	0.750	4.75	4	3.28
<input type="checkbox"/>	2 ½	7.00	2.94	0.500	0.750	5.50	4	4.50
<input type="checkbox"/>	3	7.50	3.57	0.500	0.750	6.00	4	4.88
<input type="checkbox"/>	3 ½	8.50	4.07	0.500	0.750	7.00	8	6.04
<input type="checkbox"/>	4	9.00	4.60	0.500	0.750	7.50	8	6.57
<input type="checkbox"/>	5	10.00	5.66	0.500	0.880	8.50	8	7.31
<input type="checkbox"/>	6	11.00	6.72	0.500	0.880	9.50	8	8.24
<input type="checkbox"/>	8	13.50	8.72	0.500	0.880	11.75	8	11.83
<input type="checkbox"/>	10	16.00	10.88	0.500	1.000	14.25	12	18.39
<input type="checkbox"/>	12	19.00	12.88	0.500	1.000	17.00	12	26.80
<input type="checkbox"/>	14	21.00	14.14	0.500	1.125	18.75	12	33.05
<input type="checkbox"/>	16	23.50	16.16	0.500	1.125	21.25	16	47.45
<input checked="" type="checkbox"/>	18	25.00	18.18	0.500	1.250	22.75	16	47.21
<input type="checkbox"/>	20	27.50	22.00	0.500	1.250	25.00	20	73.76
<input type="checkbox"/>	24	32.00	24.25	0.500	1.380	29.50	20	92.64
<input type="checkbox"/>	30	38.75	30.25	1.000	1.380	36.00	28	124.16
<input type="checkbox"/>	36	46.00	36.25	1.250	1.625	42.75	32	207.40

Plate Stainless Steel Flange Dimensions conform to ASME B16.5 Class 150
Plate Stainless Steel Flanges made from ASTM A240 Plate
Cast in conformance with ASTM A35