

Project Name: \_\_\_\_\_  
Job #: \_\_\_\_\_

**Class 150# - CAST FITTINGS, ASTM A351 - MSS**  
**SP114 Heavy Pattern**

**HEAVY PATTERN 45° ELBOW**

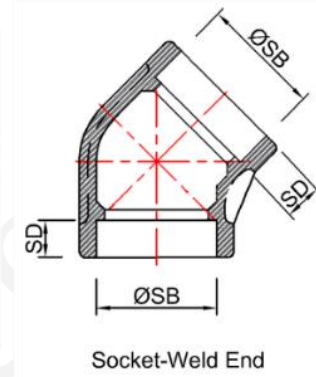
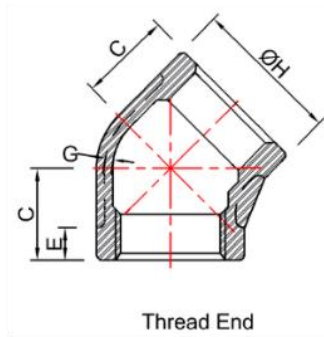

- Grade:  T304/CF8  T316/CF8M  
 Connection:  Threaded  Socket weld  
 Source:  Import  Domestic

**DIMENSIONS**

UOM: Inches/LBS

SELECT	SIZE	C	E	G	H	SB	SD
<input type="checkbox"/>	1/8	0.69	0.20	0.09	0.75	0.43	0.39
<input type="checkbox"/>	1/4	0.69	0.20	0.09	0.84	0.56	0.39
<input type="checkbox"/>	3/8	0.81	0.21	0.10	1.01	0.69	0.39
<input type="checkbox"/>	1/2	0.87	0.25	0.10	1.20	0.85	0.39
<input type="checkbox"/>	3/4	1.00	0.27	0.12	1.46	1.07	0.51
<input type="checkbox"/>	1	1.12	0.30	0.13	1.77	1.33	0.51
<input type="checkbox"/>	1 1/4	1.31	0.34	0.14	2.15	1.68	0.51
<input type="checkbox"/>	1 1/2	1.43	0.37	0.15	2.43	1.92	0.51
<input type="checkbox"/>	2	1.68	0.42	0.17	2.96	2.41	0.63
<input type="checkbox"/>	2 1/2	1.93	0.48	0.21	3.31	2.91	0.63
<input type="checkbox"/>	3	2.18	0.55	0.23	4.00	3.54	0.63
<input type="checkbox"/>	4	2.62	0.66	0.26	5.06	4.55	0.75

Thread Pattern conform to ANSI / ASME B1.20.1, NPT  
 Stainless Castings conform to ASTM A351  
 Stainless Wrought Fittings conform To ASTM A182, Barstock to ASTM A479  
 Manufactured in accordance to ISO 9001: 2000

Project Name: \_\_\_\_\_  
Job #: \_\_\_\_\_

**Class 150# - CAST FITTINGS, ASTM A351 - MSS  
SP114 Heavy Pattern**

**HEAVY PATTERN 90° ELBOW**

SOCKET-WELD END

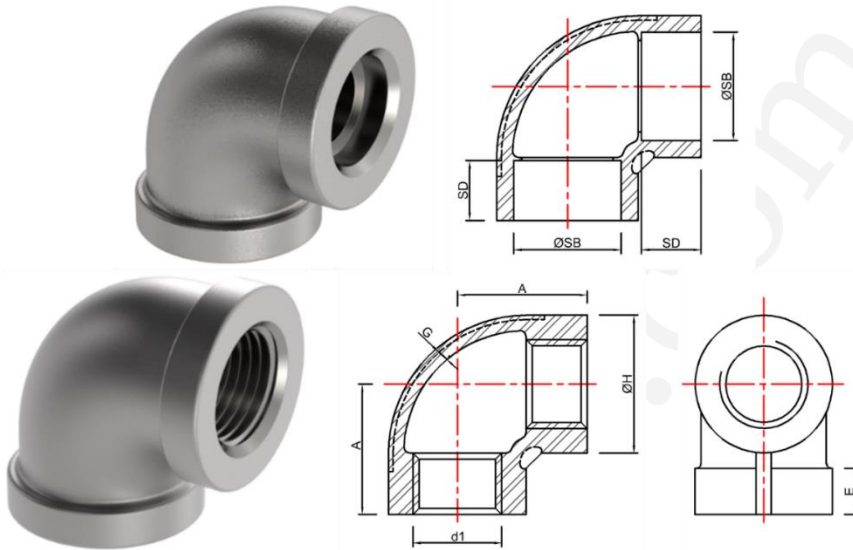

THREAD END

- Grade:  T304/CF8  T316/CF8M  
 Connection:  Threaded  Socket weld  
 Source:  Import  Domestic

**DIMENSIONS**

UOM: Inches/LBS

SELECT	SIZE	A	E	G	H	SB	SD
<input type="checkbox"/>	1/8	0.81	0.20	0.09	0.75	0.43	0.39
<input type="checkbox"/>	1/4	0.81	0.20	0.09	0.84	0.56	0.39
<input type="checkbox"/>	3/8	0.93	0.21	0.10	1.02	0.69	0.39
<input type="checkbox"/>	1/2	1.12	0.25	0.10	1.21	0.85	0.39
<input type="checkbox"/>	3/4	1.31	0.27	0.12	1.46	1.07	0.51
<input type="checkbox"/>	1	1.50	0.30	0.13	1.77	1.33	0.51
<input type="checkbox"/>	1 1/4	1.75	0.34	0.14	2.15	1.68	0.51
<input type="checkbox"/>	1 1/2	1.93	0.37	0.15	2.43	1.92	0.51
<input type="checkbox"/>	2	2.25	0.42	0.17	2.96	2.41	0.63
<input type="checkbox"/>	2 1/2	2.68	0.48	0.21	3.31	2.91	0.63
<input type="checkbox"/>	3	3.06	0.55	0.23	4.00	3.54	0.63
<input type="checkbox"/>	4	3.81	0.66	0.26	5.06	4.55	0.75

Thread Pattern conform to ANSI / ASME B1.20.1, NPT  
 Stainless Castings conform to ASTM A351  
 Stainless Wrought Fittings conform To ASTM A182, Barstock to ASTM A479  
 Manufactured in accordance to ISO 9001: 2000

**Class 150 # - CAST FITTINGS, ASTM A351 -  
Regular Pattern**

**90° ELBOW - STREET**

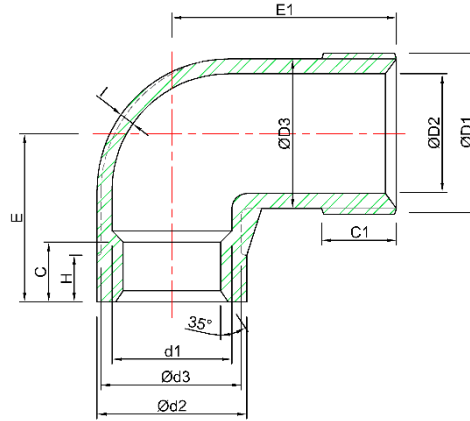

- Grade:  T304/CF8  T316/CF8M  
 Connection:  Threaded  
 Source:  Import  Domestic

**DIMENSIONS**

UOM: Inches/LBS

SELECT	SIZE	d1	d2	d3	C	E	H	D1	D2	D3	C1	E1	I
<input type="checkbox"/>	1/8	1/8	0.59	0.47	0.28	0.71	0.20	1/8	0.20	0.35	0.31	1.02	0.08
<input type="checkbox"/>	1/4	1/4	0.71	0.59	0.41	0.87	0.20	1/4	0.24	0.47	0.43	1.22	0.08
<input type="checkbox"/>	3/8	3/8	0.89	0.79	0.41	0.87	0.24	3/8	0.35	0.55	0.43	1.54	0.08
<input type="checkbox"/>	1/2	1/2	1.10	1.02	0.39	1.06	0.31	1/2	0.55	0.75	0.51	1.61	0.08
<input type="checkbox"/>	3/4	3/4	1.42	1.30	0.47	1.30	0.35	3/4	0.79	0.98	0.51	1.85	0.08
<input type="checkbox"/>	1	1	1.77	1.65	0.55	1.46	0.35	1	0.98	1.22	0.73	2.09	0.08
<input type="checkbox"/>	1 1/4	1 1/4	2.05	1.97	0.67	1.73	0.43	1 1/4	1.30	1.56	0.75	2.48	0.10
<input type="checkbox"/>	1 1/2	1 1/2	2.36	2.24	0.67	1.85	0.43	1 1/2	1.57	1.83	0.75	2.72	0.10
<input type="checkbox"/>	2	2	2.87	2.72	0.71	2.32	0.51	2	1.97	2.24	0.85	3.15	0.10
<input type="checkbox"/>	2 1/2	2 1/2	3.54	3.39	0.91	2.60	0.59	2 1/2	2.24	2.60	0.94	4.13	0.16
<input type="checkbox"/>	3	3	4.17	3.98	0.94	3.09	0.65	3	2.91	3.19	1.14	4.45	0.16
<input type="checkbox"/>	4	4	5.14	5.04	1.02	3.86	0.77	4	3.82	4.17	1.34	5.12	0.16

Thread Pattern conform to ANSI / ASME B1.20.1, NPT  
 No Lead  
 Stainless Wrought Fittings conform To ASTM A182, Barstock to ASTM A479